



---

PATIENT & CAREGIVER EDUCATION

# Nonin 3230 Pulse Oximeter: Patient Remote Monitoring

This information explains how to use your Nonin 3230 pulse oximeter.

## Overview

Your healthcare provider would like you to use a pulse oximeter to check your oxygen levels from home. This device lets your care team monitor your oxygen levels and provide help as early as possible.

Please view these instructions on how to set up and take a reading using your pulse oximeter. If you have questions, please call your healthcare provider's office.

## How to set up your Nonin 3230 pulse oximeter

1. Slide off the back cover of the pulse oximeter (see Figure 1) and install two AAA batteries (see Figure 2).
2. Slide the cover back on.

Your Nonin pulse oximeter is ready to take a reading.



Figure 1. Slide off the back cover

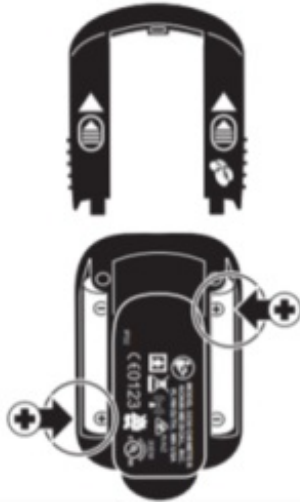

Figure 2. Install two AAA batteries

## How to take a reading with your Nonin 3230 pulse oximeter

1. Open the MSK Remote Monitoring app and log in with your MyChart username and password (see Figure 3).

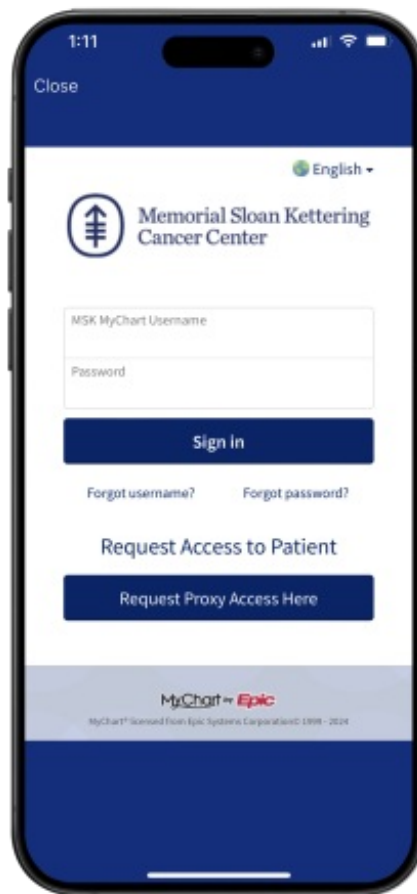

Figure 3. MSK Remote Monitoring app

2. Review the authorization screen and select “Continue” (see Figure 4).

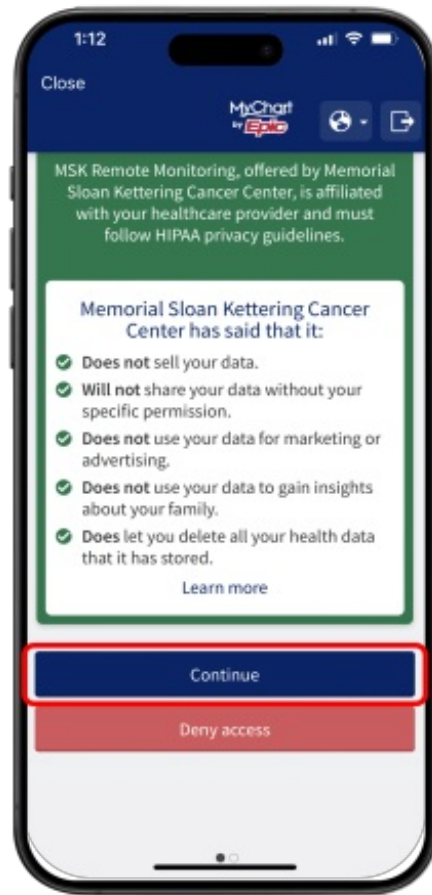

Figure 4. Authorization screen

3. Review the data authorization screen and select a time range. Then tap “Allow access” (see Figure 5).

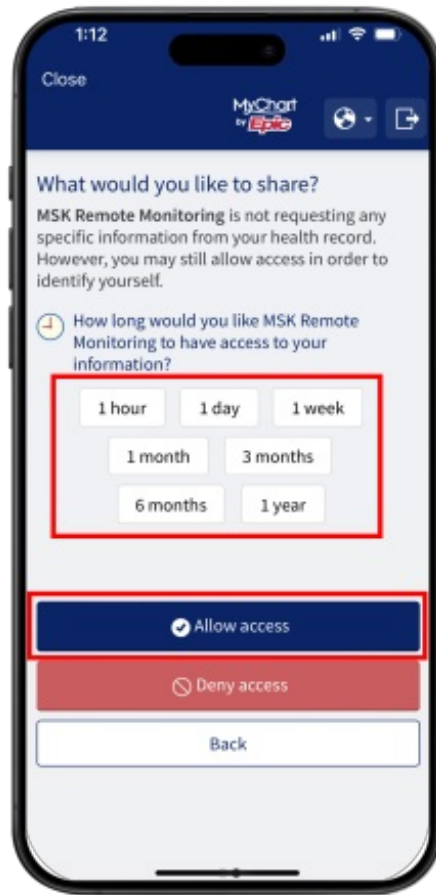

Figure 5. Allow access

4. You will see the Devices screen. Look for the Pulse Oximeter tile. Select “Nonin 3230” (see Figure 6).



Figure 6. Select device

5. Put the pulse oximeter on any of your 3 middle fingers (not your thumb or pinky). The display should face you (see Figure 7).



Figure 7. Place device on your finger

---

6. With the pulse oximeter on your finger, select “Take a reading” (see Figure 8).

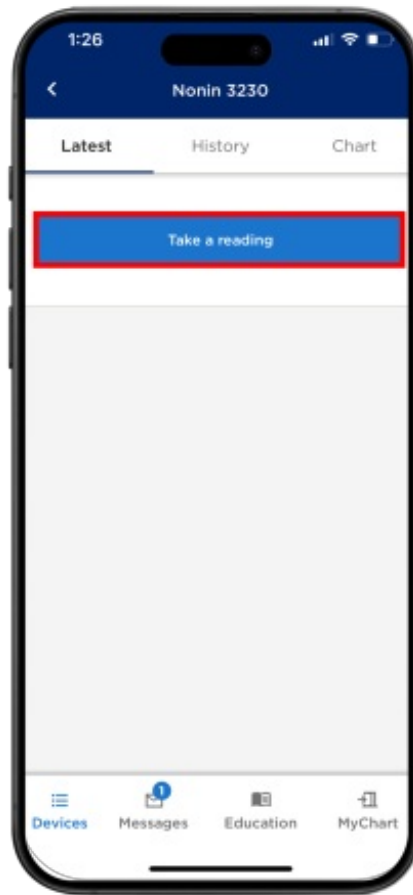

Figure 8. Take a reading

7. The MSK Remote Monitoring app will need permission to connect to Bluetooth devices. Tap “Allow” when asked to connect to Bluetooth (see Figure 9).



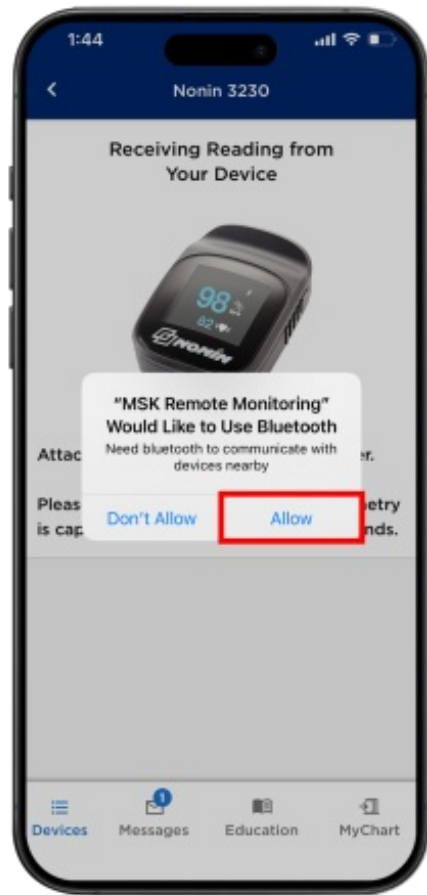

Figure 9. Allow to pair device

8. Select “Pair” (see Figure 10). This connects your Nonin 3230 pulse oximeter to your phone.



Figure 10. Start to pair device

9. Your device will start to take a reading (see Figure 11). This may take up to 10 seconds.



Figure 11. Device taking a reading

---

10. When you see your reading, select “Submit” (see Figure 12). This will send your reading to MSK.

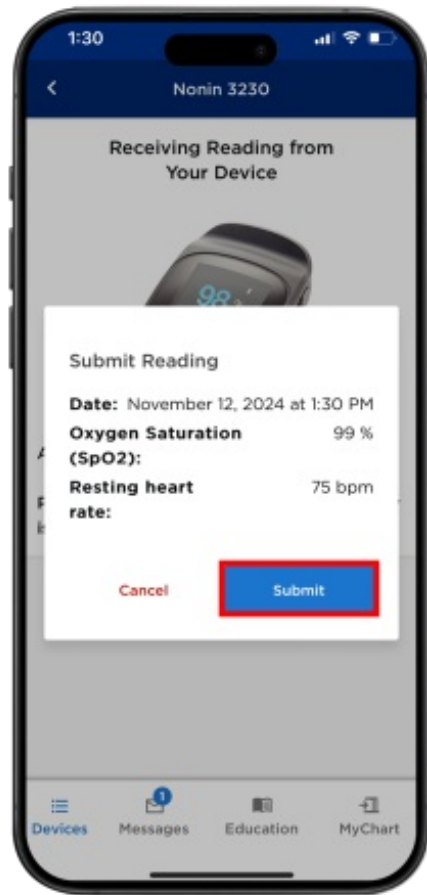

Figure 12. Submit your reading

11. You can see your new reading on the screen (see Figure 13). It also will be sent to your care team at MSK.

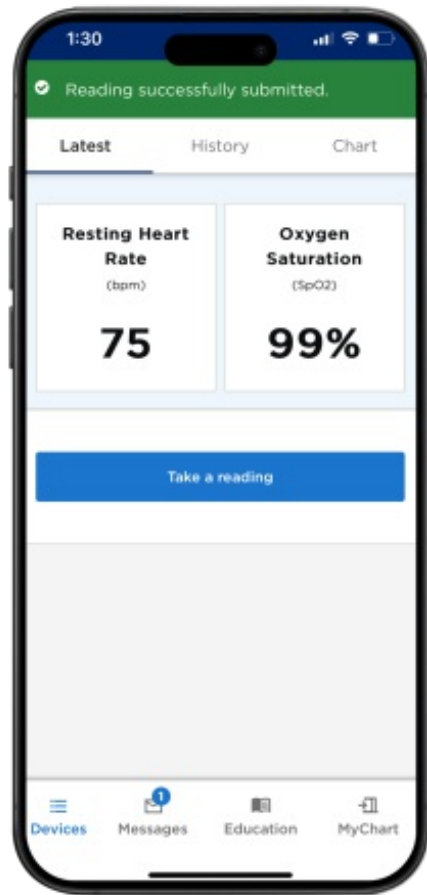

Figure 13. Your new reading on screen

---

## Low battery alert

A low battery symbol (see Figure 15) will appear on the Nonin device when batteries need to be changed.

When the battery is very low, it will appear on the full screen and the device will not work. You will need to change the batteries.



Figure 15. Low battery symbol

---

If you have questions or concerns, contact your healthcare provider. A member of your care team will answer Monday through Friday from 9 a.m. to 5 p.m. Outside those hours, you can leave a message or talk with another MSK provider. There is always a doctor or nurse on call. If you're not sure how to reach your healthcare provider, call 212-639-2000.

For more resources, visit [www.mskcc.org/pe](http://www.mskcc.org/pe) to search our virtual library.

---

Nonin 3230 Pulse Oximeter: Patient Remote Monitoring - Last updated on January 30, 2025  
All rights owned and reserved by Memorial Sloan Kettering Cancer Center